

DOORSNEET

	A	B	C	D
	5400	1800	5400	
		100	2600	100
variabel	5300	100	1800	100
			5200	400

$P = \geq 20 \text{ m}^2$
 $Q = 31,5 \text{ m}^2$
 $R = 38,8 \text{ m}^2$
 $T = \geq 20 \text{ m}^2$

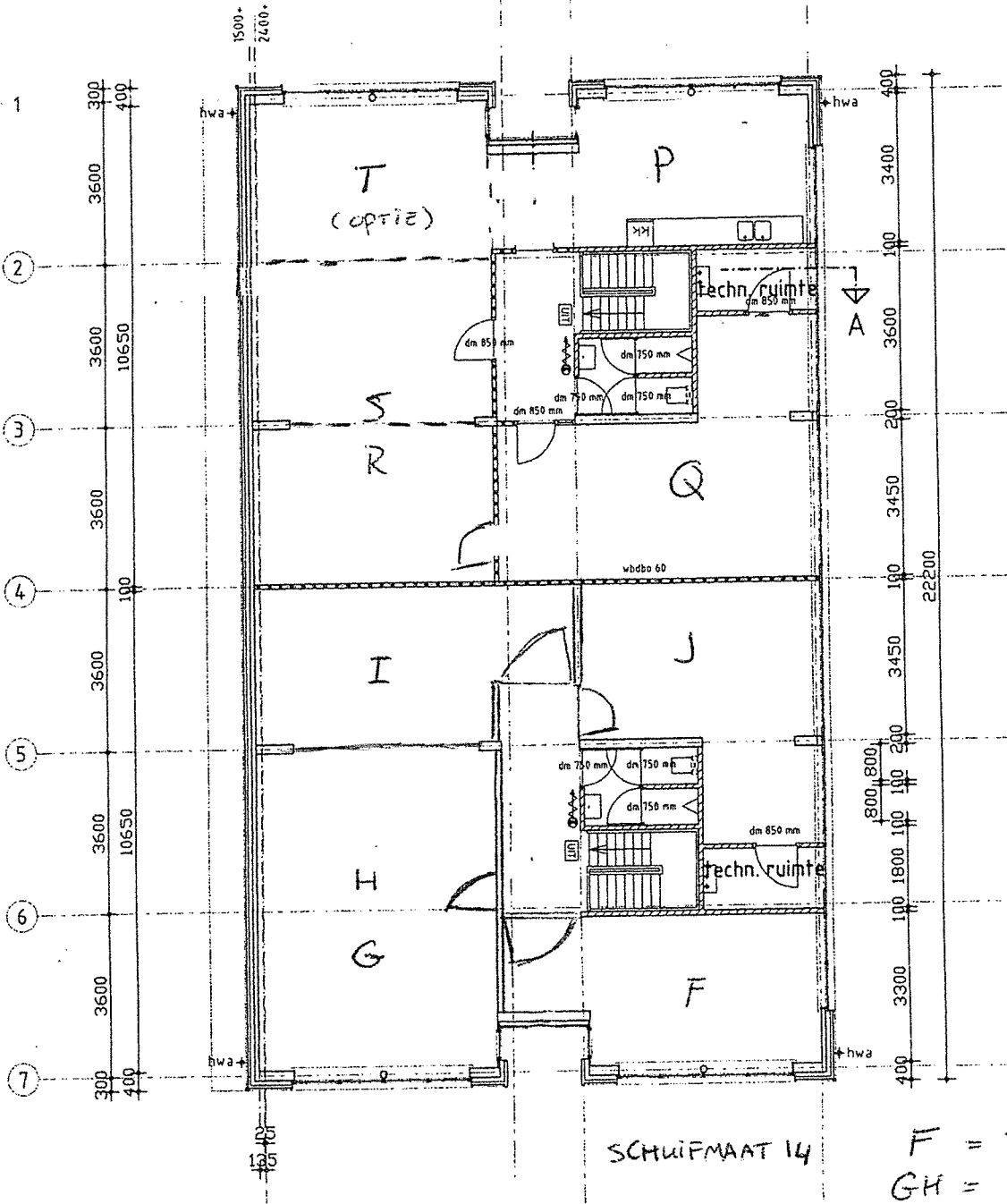

SCHUIFMAAT 14

SCHUIFMAAT 14

1e VERDIEPING

$F = 23,8 \text{ m}^2$
 $GH = 38,8 \text{ m}^2$
 $I = 23,8 \text{ m}^2$
 $J = 24,1 \text{ m}^2$

14115